

# Flow monitor for liquid media



## flow-captor 412x.8xM S140

The flow-captor type 412x.8xM S140 is used in automation processes and other industrial applications where liquid media must be monitored. The sensor works according to the calorimetric measuring principle and without mechanically moved parts. The flow-captor detects the flow velocity of the medium and converts it into an electrical signal.

- robust metal construction (M)
- plug design for Brad-Harrison coupling (S140)
- separate setting of "Range" and "Set-point"
- pressure resistant up to max. 100 bar
- analogue display of flow condition and switching point via LED chain
- **ISO 9001:2015**



Technical data		
Type	<b>4120.8xM S140</b>	<b>4121.8xM S140</b>
Medium	water-based	oil-based
Sensor data *1		
Measuring range	0 - 20 cm/s to 0 - 300 cm/s, cont. adjust	0 - 30 cm/s to 0 - 300 cm/s, cont. adjust
Set-point range	approx. 15 % - 90 % of measuring range setting	
Medium temperature	- 20 °C to +80 °C	
Ambient temperature	- 20 °C to +70 °C	
Pressure	max. 100 bar (1000 Kpa)	
Response time	2 sec. - 10 sec., according to range setting	2 sec. -15 sec., according to range setting
Linearity deviation	< 5 % <sup>1)</sup>	< 5 % <sup>2)</sup>
Repeatability	< 2 %	
Hysteresis	approx. 10 %	
Mechanical data		
Protection class	IP67	
Material housing	stainless steel AISI 303	
Material of sensor probe	stainless steel AISI 303; (A: AISI 316Ti; B: Titanium; C: Hastelloy® C4; or D: Hastelloy® C22 on request)	
Thread	G ½" BSP alt. ½" - 14 NPT	
Housing dimensions ODxH	see drawing	
Electrical connection	Brad-Harrison male socket, 5-pin (order cable type 4930E separately)	
Electrical data		
Operating voltage	90 - 250 VAC/DC	
Power consumption	-	
Switching current	≤ 5 A (120 VAC), ≤ 3 A (250 VAC), max. 5 A 150 W at VDC	
Initial operation	approx. 10 sec. after connection of power	
Electrical output	relay with potential contact	
Flow < set-point	.80	.81
- LED, green	off	off
- Output relay	activated	not activated

<sup>1)</sup> data relate to water <sup>2)</sup> calibrated with insulation oil type "Shell Diala"

# Flow monitor for liquid media

## flow-captor 412x.8xM S140



Anschlussdiagramm  
Connection diagram

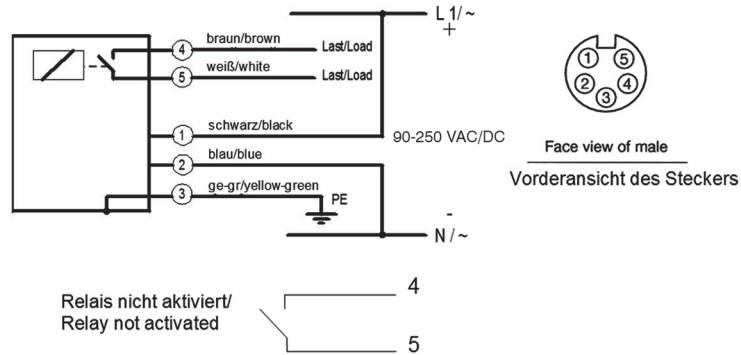

Gehäuseabmessungen  
Dimensions

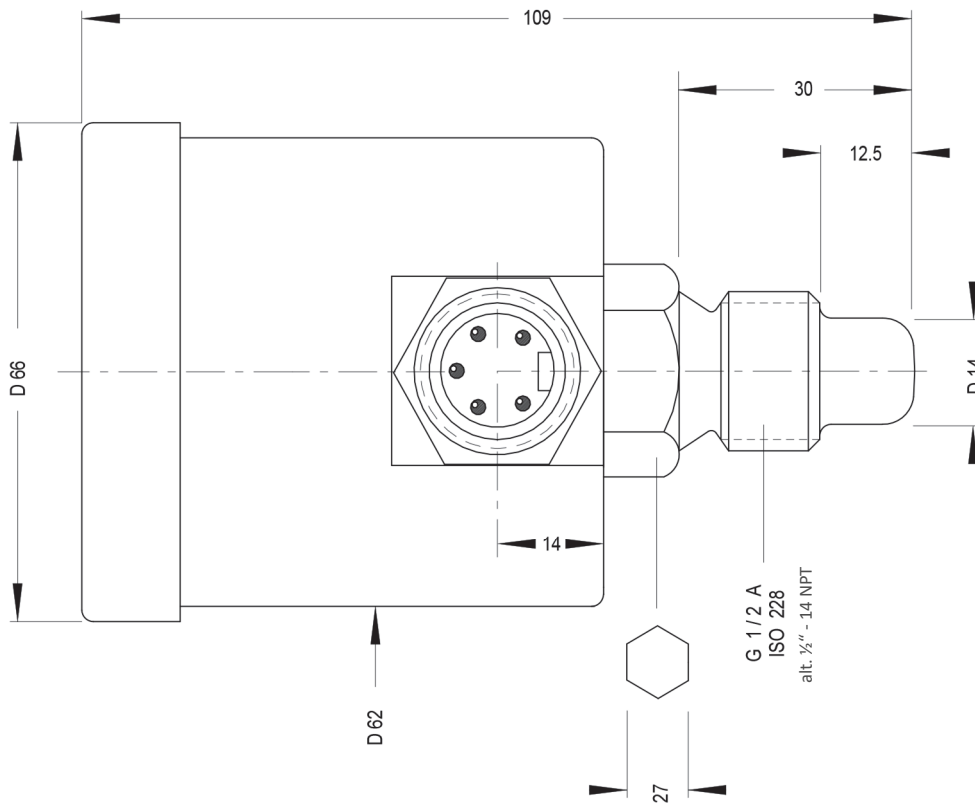

**weber**

Sensors GmbH Strohdreich 32

Sensors Ltd. 66 Eastbourne Road, Southport

Sensors LLC. 4462 Bretton Court, Building 1, Suite 7

DE-25377 Kollmar

Merseyside PR8 4DU, UK

Acworth, Georgia 30101, USA

Tel.: +49 (0)4128 - 591 · Fax: - 593

Tel.: +44 (1704) - 551684 · Fax: - 551297

Tel.: +1 (770) 592 - 6630 · Fax: - 592 6640

**www.captor.de**

info@captor.de

sales@captor.co.uk

sales@captor.com